

测压软管及测压接头

4、外螺纹式 HFE *

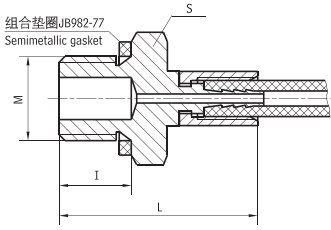

E*	M	I	L	S	备注remark
E1	M14×1.5	12	34	19	
E2	G1/4	12	34	19	
E3	M12×1.5	12	35	17	
E4	M10×1	8	30	17	
E5	G1/8	8	30	17	

5、外锥螺纹式 HFT*

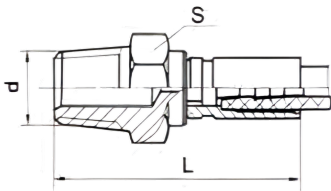

T*	d	I	L	S	备注remark
T11	1/8"-27NPTF	11	33	13	
T12	1/4"-18NPTF	16	37	16	
T13	3/8"-18NPTF	16	37	19	

6、内螺纹内锥面式 Inside screw thread:HFC *

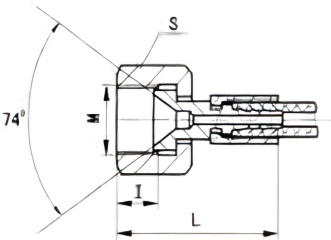

C*	M	I	L	S	备注remark
C1	M10×1	7	31	15	
C2	M12×1.25	8	31	17	
C3	M14×1.5	8	31	17	
C4	M16×1.5	10	33	19	
C5	M12×1	10	33	19	
C6	M14×1	12	35	22	
C21	7/16"-20UNF	10	33	15	
C22	1/2"-20UNF	10	33	17	
C23	9/16"-18UNF	12	35	19	

7、铰接式 Adjustable fitting: HF J*

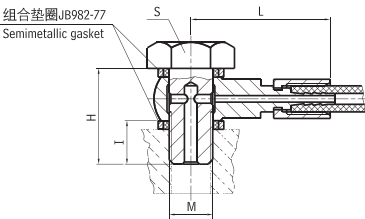

J*	M	H	B	d	L	S	组合垫圈 Semimetallic gasket	备注remark
J1	M10×1	20	8	10.2	35	15	10	
J2	M14×1.5	25	10	14.2	39	19	14	
J3	G1/8	20	8	10.2	35	15	10	
J4	G1/4	25	10	14.2	39	19	14	
J5	M8×1	20	8	8.2	33	14	8	
J6	M12×1.5	25	12	12.2	35	17	12	